

The design from this building stems equally from the native culture of the site as it does from the consideration of the needs of the school children -- in their education, safety, and the preservation of their homeland.

The material of the walls, hempcrete, hearkens to the Mo belief indigenous to the region -- as a synthesis of earth and sky, two of the primary elements in Mo cosmology.

The enclosed courtyard references siheyuan, or courtyard houses, that have been popular in Asia since the Western Zhou period. It also allows for a greater appreciation of the surrounding flora, as well as provides for a safe density under 2 children per square meter.

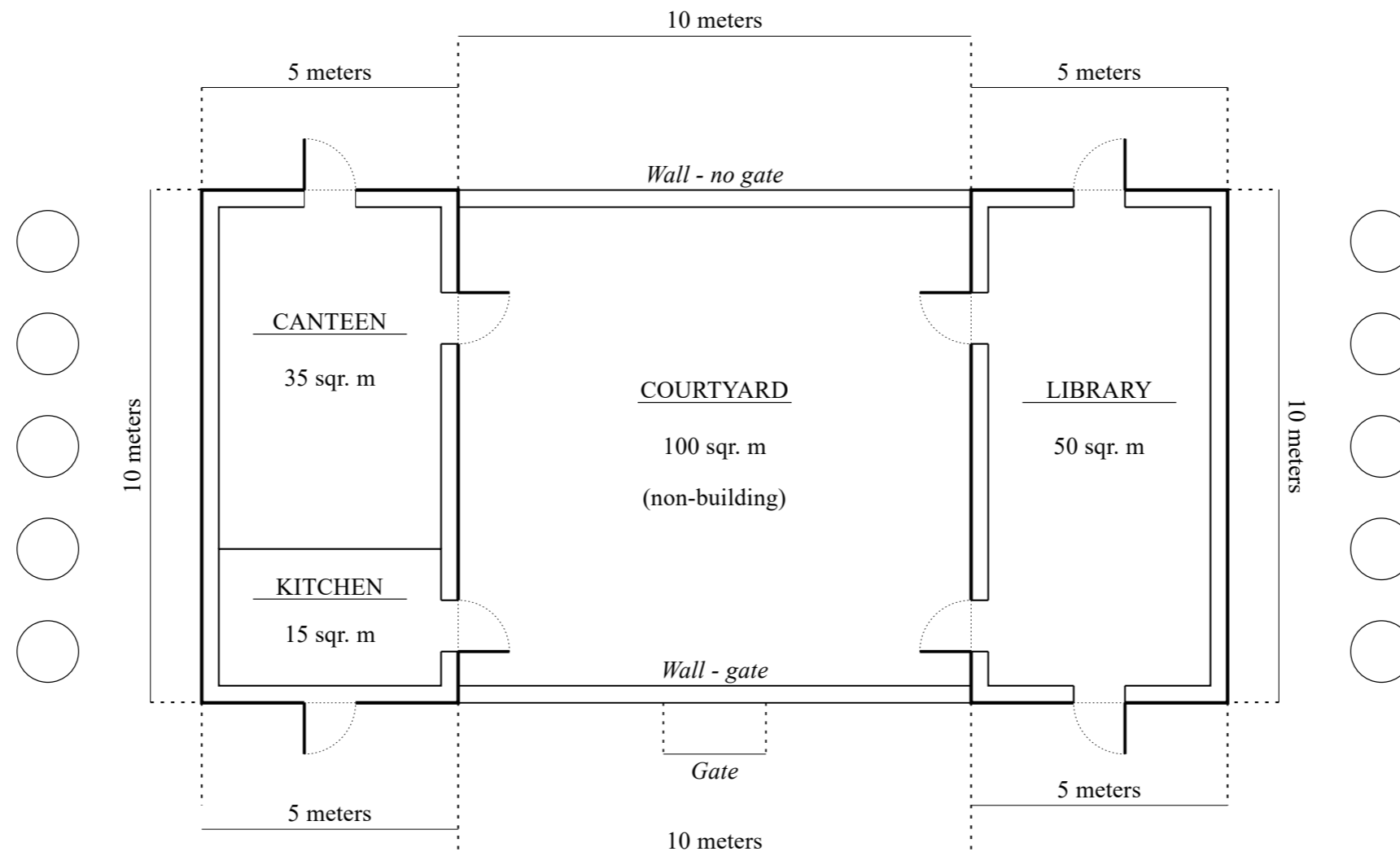
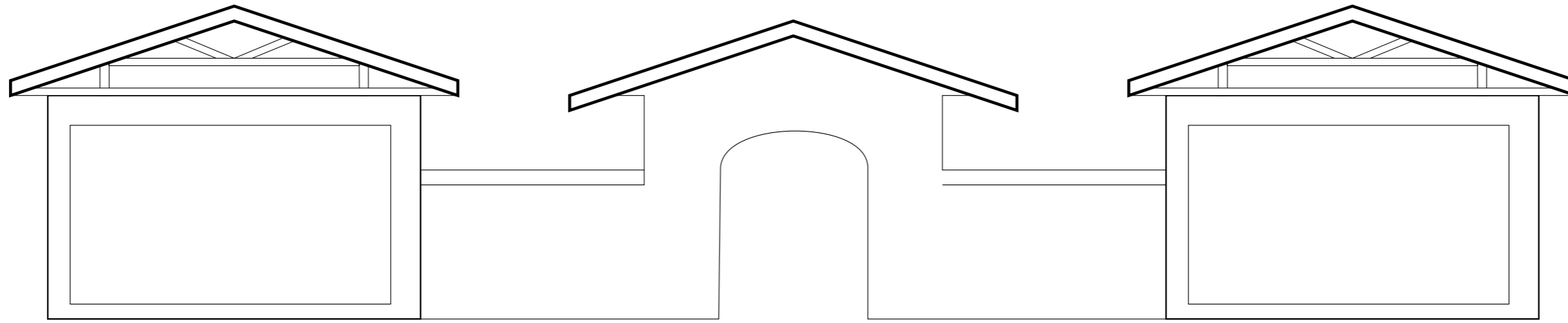

Team 3307