

# REDEFINING THE SKYLINE

## FORM DEVELOPMENT

Skyline of Pu'an



The natural diversity of the Pu'an should be maintained. Hence to create balance, the mass is divided into built and unbuilt.

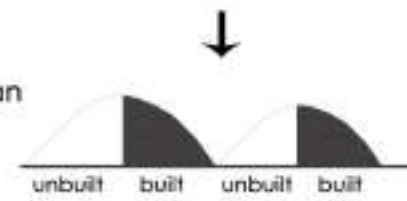

Final Form

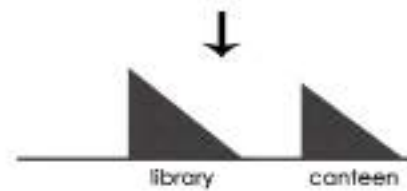

Our proposal acknowledges the beauty of Pu'an county and tries to redefine and retain the skyline of the place. In this proposal a modern form is introduced without losing the originality of place in terms of materials and building techniques.

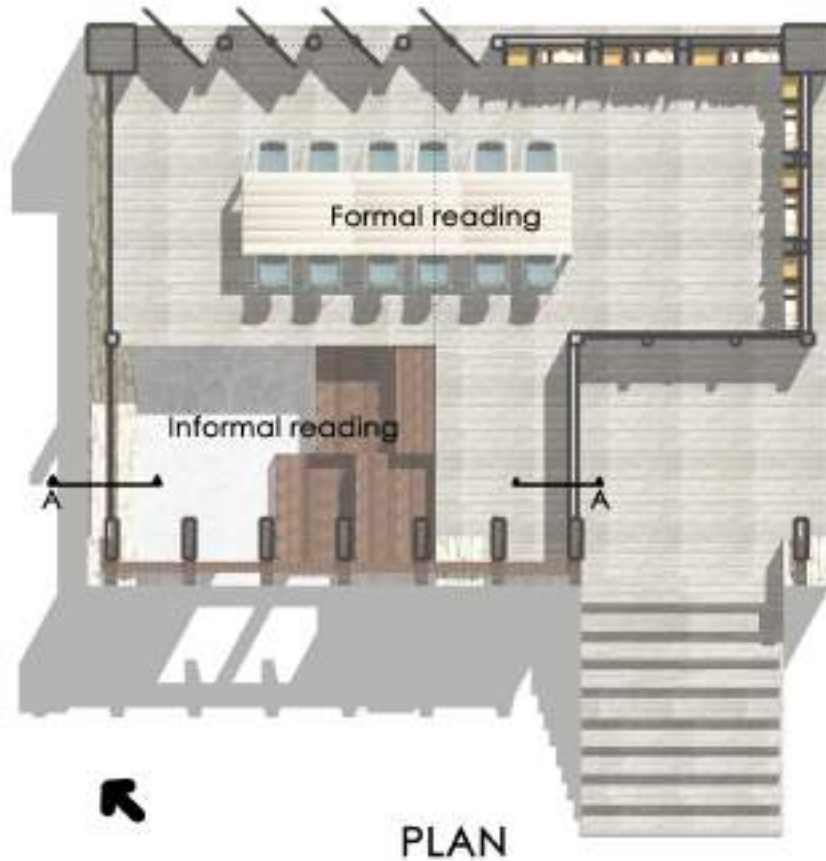

PLAN

## LIBRARY-65M<sup>2</sup>

The whole space is divided into two areas- formal and informal reading space. At entrance small outdoor open space is provided, as in buyi's houses, which is used for waiting, conversation. Transperent skin provided in north side to welcome natural light and also to provide breathtaking views over Pu'an landscape. Pivoted panels are provided to regulate the amount of light entering inside.

The informal reading space consists of wooden sitting cum stairs with bookshelves on the ground level.

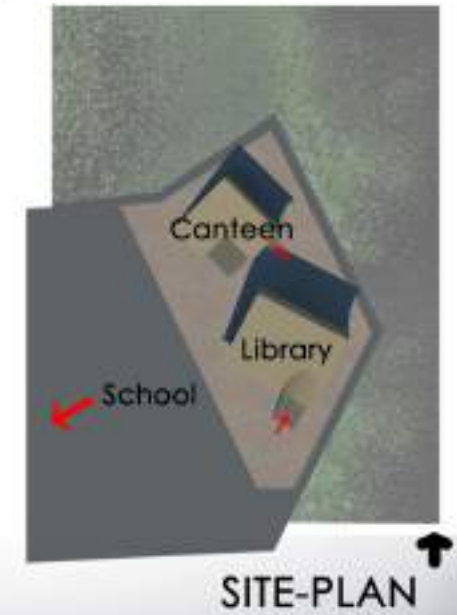

SITE-PLAN

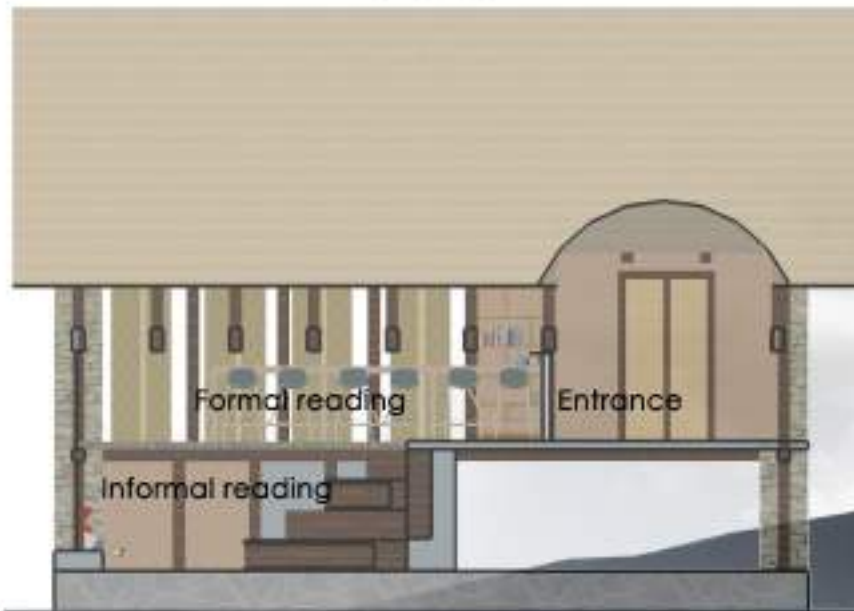

SECTION A-A







FORMAL READING-LIBRARY

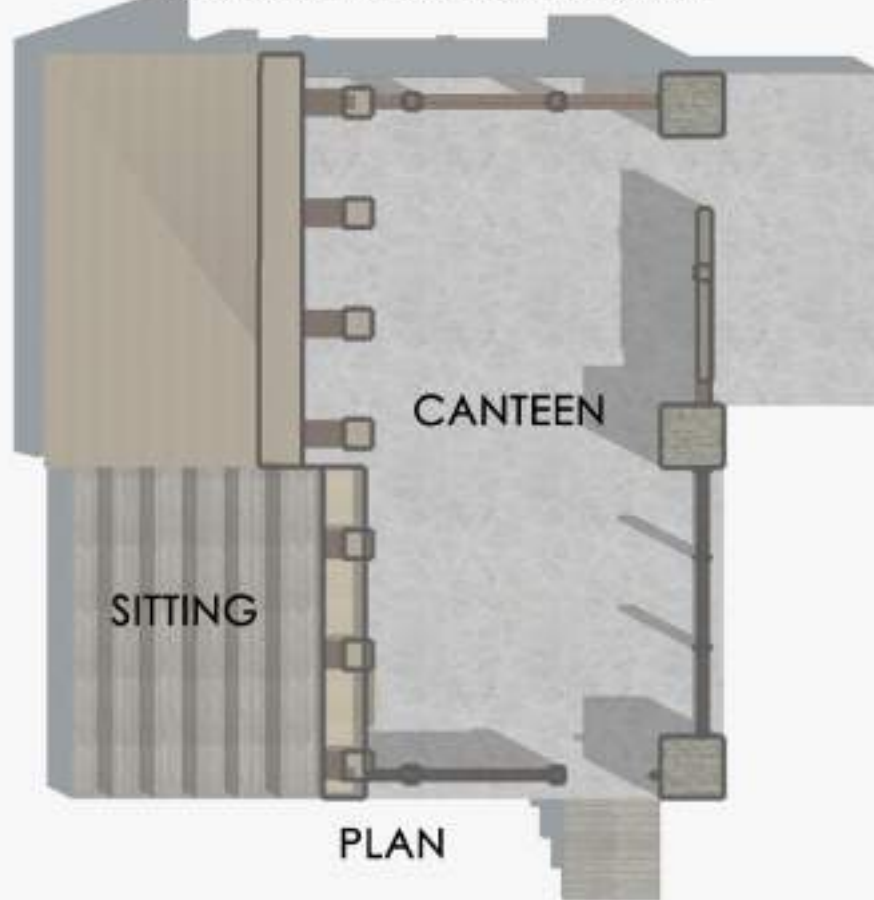

PLAN

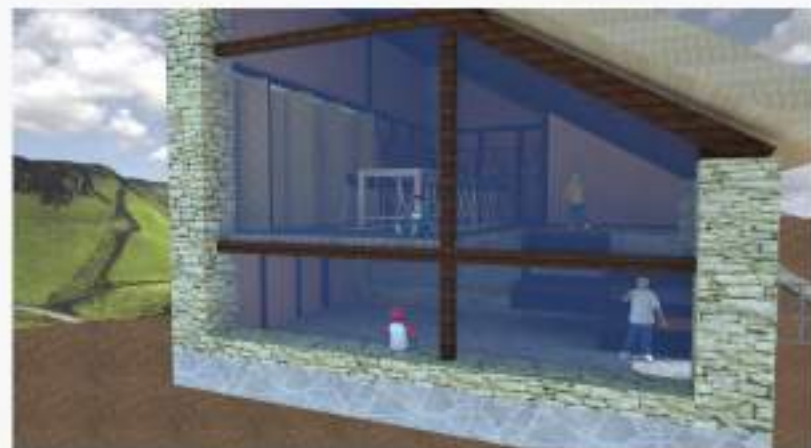

LIBRARY

MATERIALS-

The material of the structure is mixture of vernacular and contemporary.

Locally available material used-

- stones
- timber
- thatch
- bamboo

Transported material

- glass

Rice husk wall panels

There is lot of rice cultivation so rice waste is used as material in building. The rice husk wall panels are used for walls. These panels can also be moulded on site. The panels are lightweight and cheap.

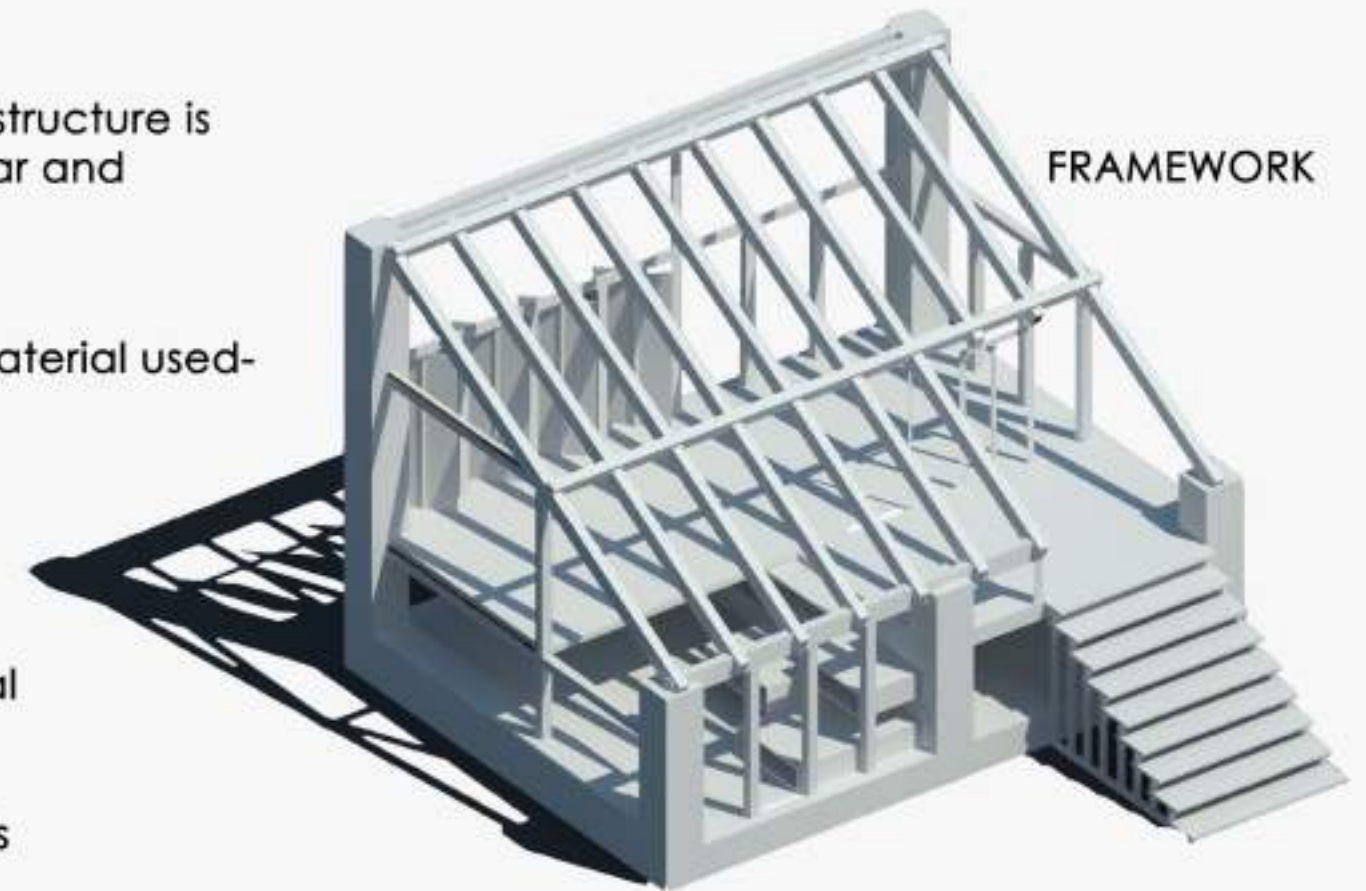

CANTEEN-35M<sup>2</sup>

The canteen is a structure having one side sloped roof with inbuilt steps. These steps are used as sitting space.

