

FREEZE!

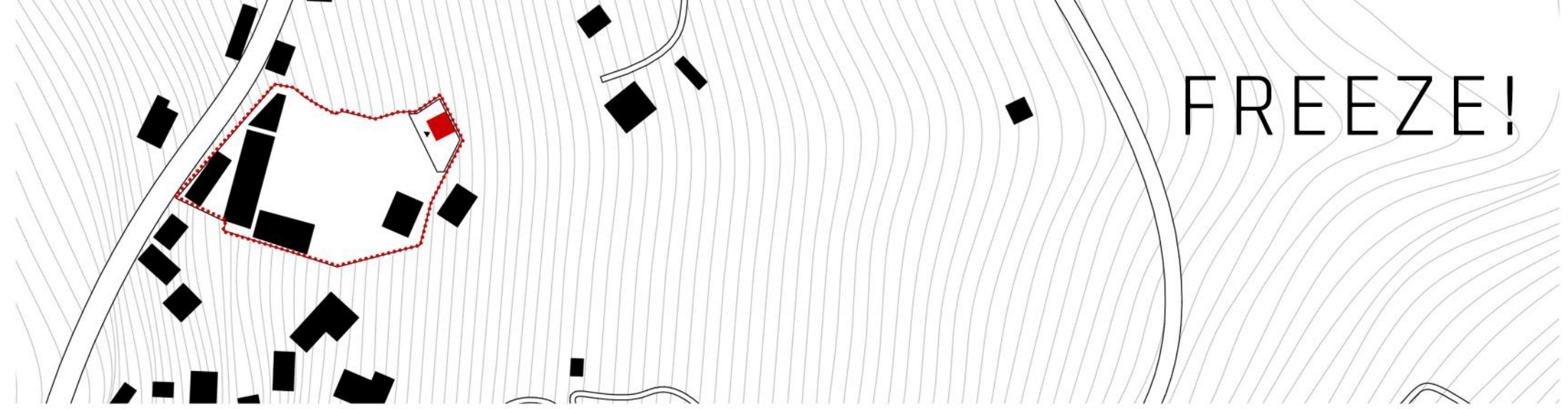

LOCATION 1:2000

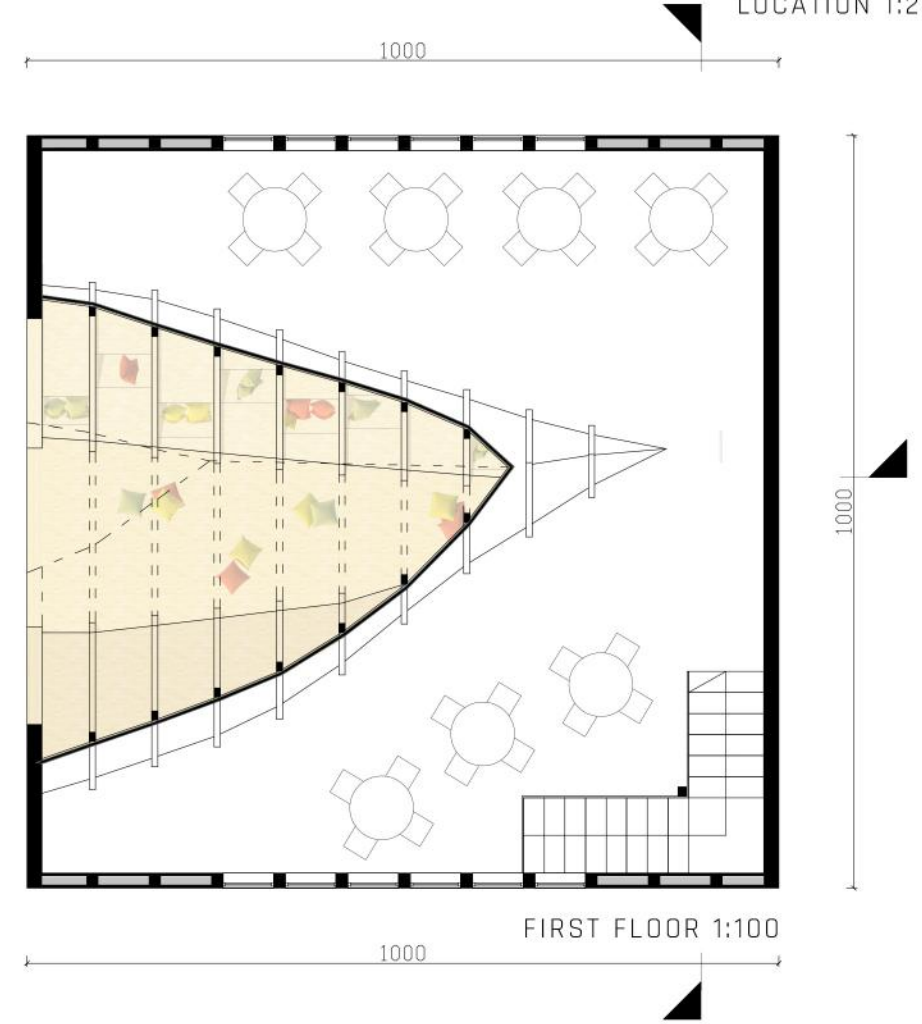
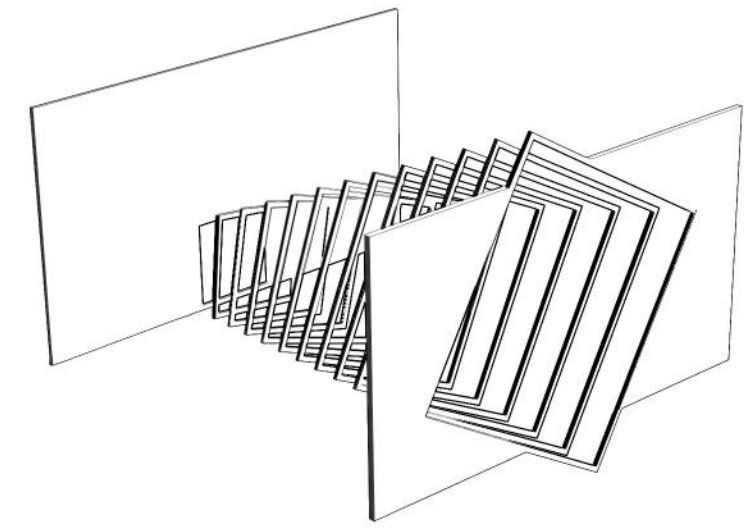
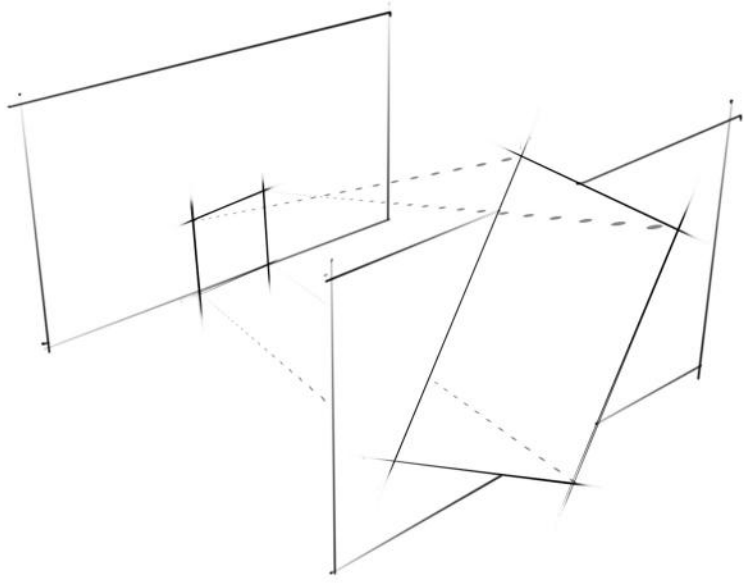
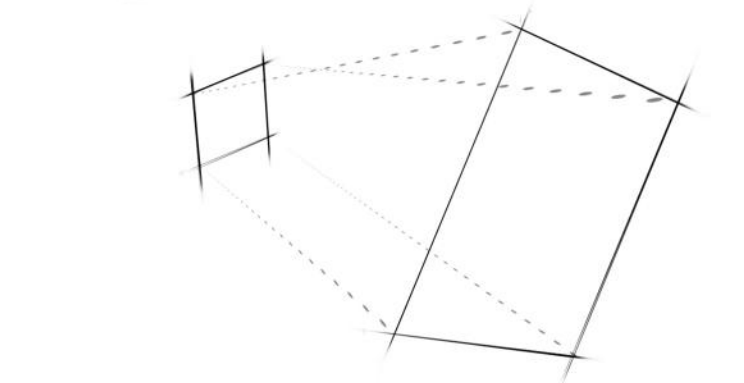
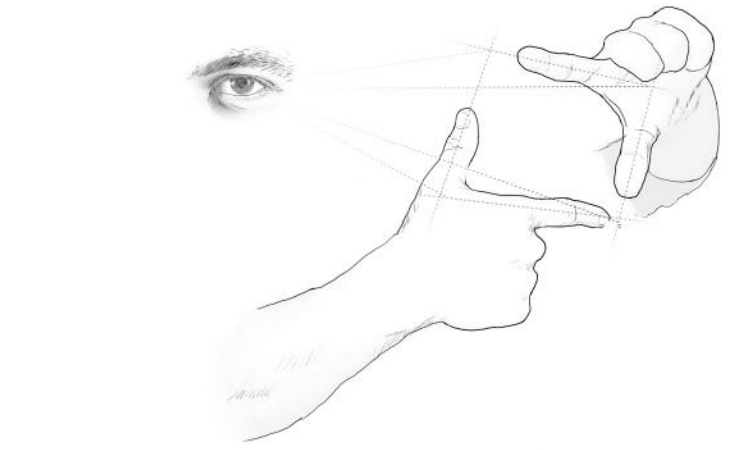

Evanescence - phenomenon so cruel, so ruthless, destroying passing moments we struggle to catch. And there is nothing as elusive as childhood. Structure is a metaphor, a symbolic way to hold these special moments down. The aim is to raise the youth emphasizing, what they should never forget- their homeland with its stunning landscape frozen in frame, frozen to last longer than just a while.

The object does not show its face at sight. It delights with ascetical aspect guiding and focusing on surroundings just after the threshold is crossed. Proposed plan consists of library at the ground floor and canteen zone upstairs, everything is affected by common space in form of squared lunette transfixing the block, forming an axis of integration amongst inhabitants. This sort of airy shed has its grounds in the prevailing climate. Interior is designed with combined storey, that delivers more seats for melancholic, rainy days.

General construction is based on two reinforced concrete walls, with 11 wooden frames between them. Distorsion of frames - geometrical play with size and rotation is what creates unforgettable character of interiors and slanting walls and used as furniture elements. Other two walls consists of light, wooden pillars, that lets the sun to enter interior spaces.

