

raw

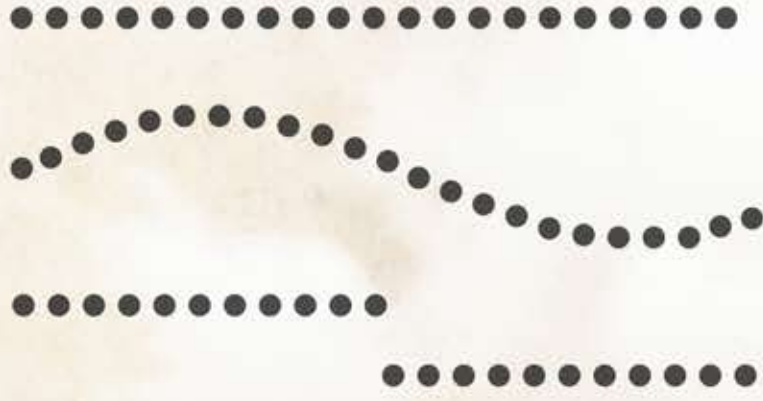



What led man to shift from the primitive cave to the universal wall and roof structures of today? When did it become an amalgam of multiple spaces defined by their functional attributes? We ask ourselves the question as to how man can return to his most basic being.

Isn't it ironic that man has to commit a heinous crime to get back to the rawest, most basic form of living whose design transcends space, time and place? A prison is such a space where man is restrained by walls and constrained by lack of materials to express his sense of individuality.

The sense of punishment that is conventionally associated with basic raw living is abolished in this design. In a capsule, we are essentially breaking down the conventional programmed thinking of a living space while preserving the essence of a house by providing a person with raw materials and endless opportunities to compose his own space.

If people are given the freedom of function, could it be the new dimension of architecture?

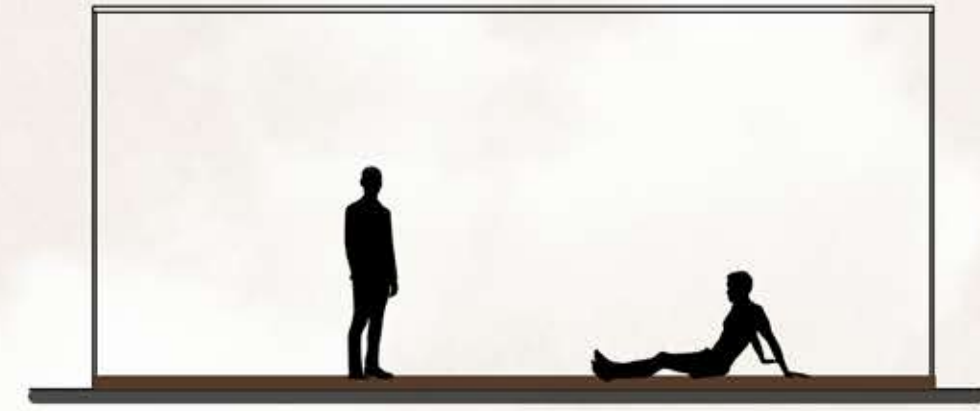

section

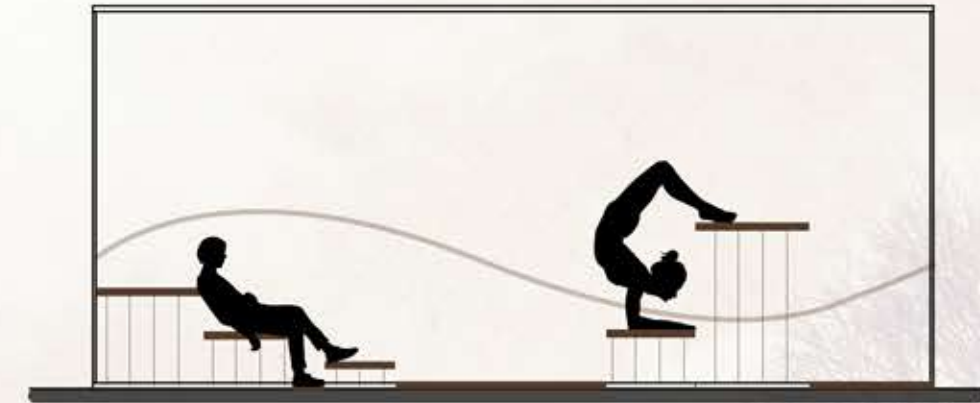

section



section

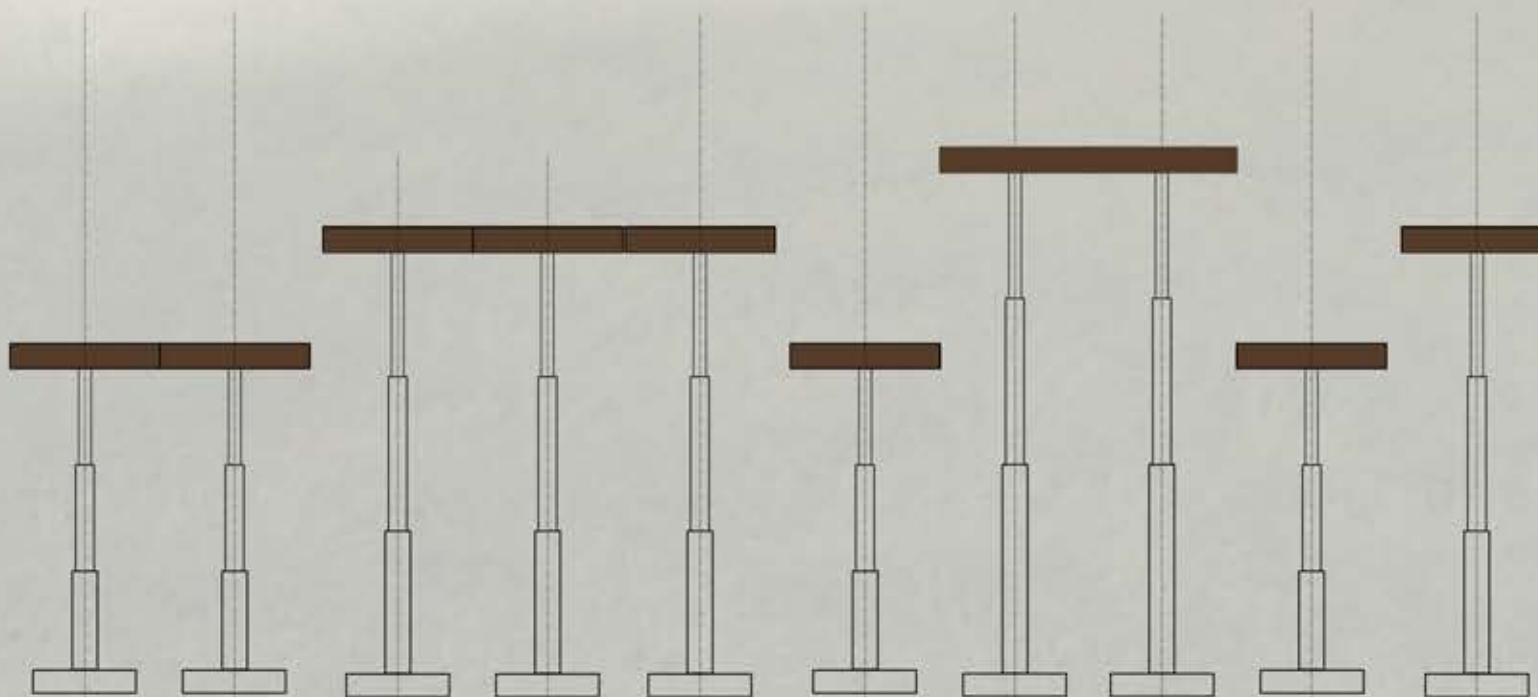

retractable floor pins



plan