

# [boundless] metamorphosis

*Venustas* which is based on the universal laws of proportion and symmetry, according to Vitruvius, is one of the pivotal themes that an architect ought to focus on prior to an unsullied venture. The most essential objective of architecture is to allow humans to appreciate the exquisiteness of this cosmos in its most pristine form. This project is capable of dissolving the boundaries between the animate and inanimate, between here and there, between interior and exterior, and between natural and artificial. It has liquefied to an extent that it ceases to be an installation; it has become landscape. Because of flexibility in design, the project will be in a perpetual state of transformation. Free from the clutches of constraints akin to site and programme, it translates into a space which allows humans to feel one with their surroundings and not just mere spectators.







*section*

*repetitive module each of 4.3 m  
in height and the cave at the  
bottom*

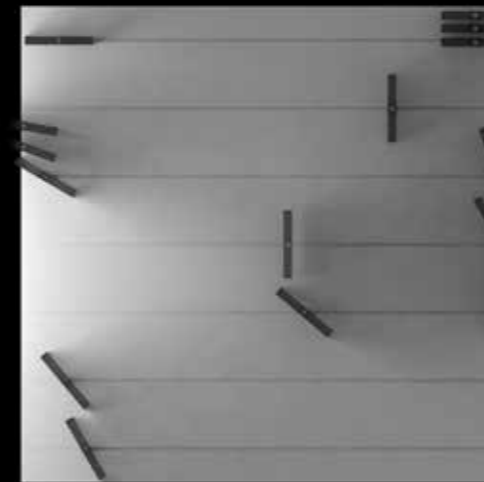

*plan*

*7x7 m module with mobile  
louvers, based on the Golden  
Ratio.*

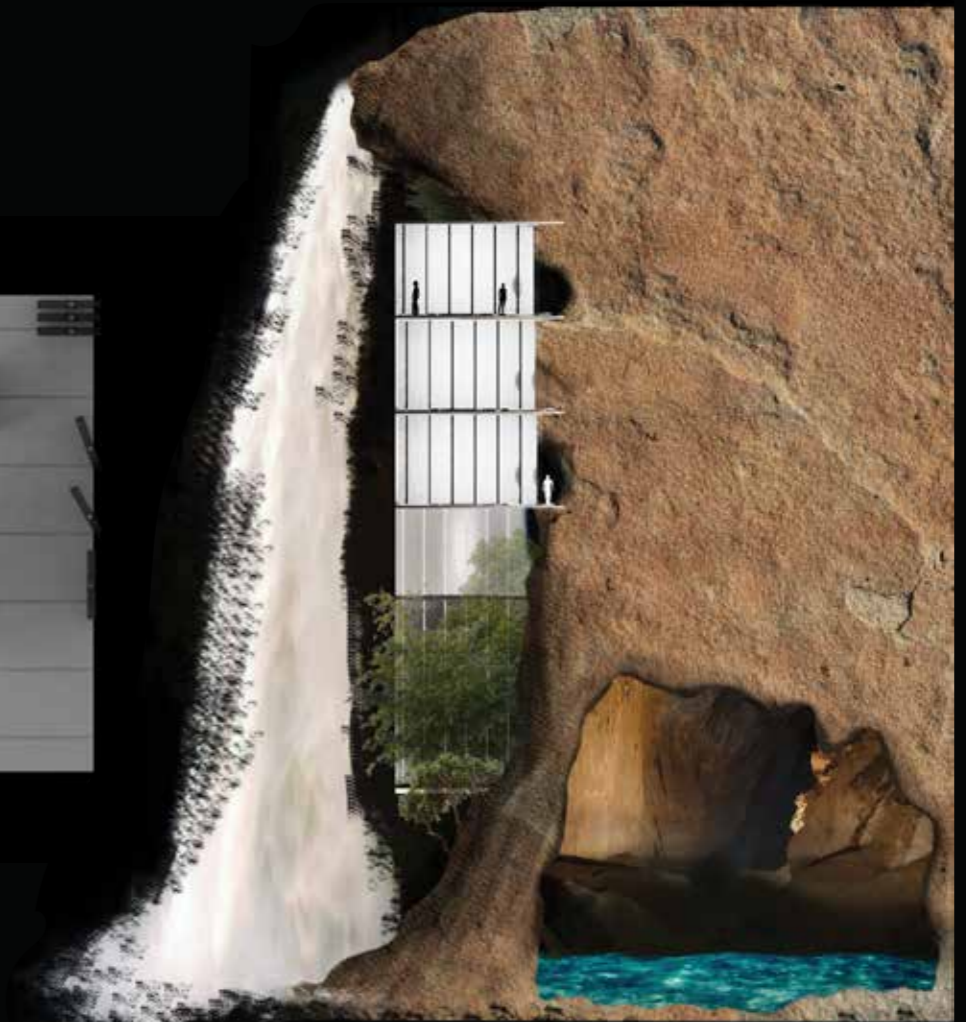

...and since nature's most perfect object is man, a perfect building should be proportioned like a human body.

