

## *We measure things we care about*

The gentle slopes of Toyen Park offer an escape from city life. Inspired by this, the pavilion attempts to break free from a dictated box; the undulations of a lifted plane invites exploration. The site is central and well traversed, offering an ideal meeting point.

The arranged spheres represent abstracted versions of systems influencing sustainability. Each explores issues of scale and sense, informing users and providing interaction. The pavilion is covered with artificial grass, alluding to the artificial use of greenery in "sustainable architecture".

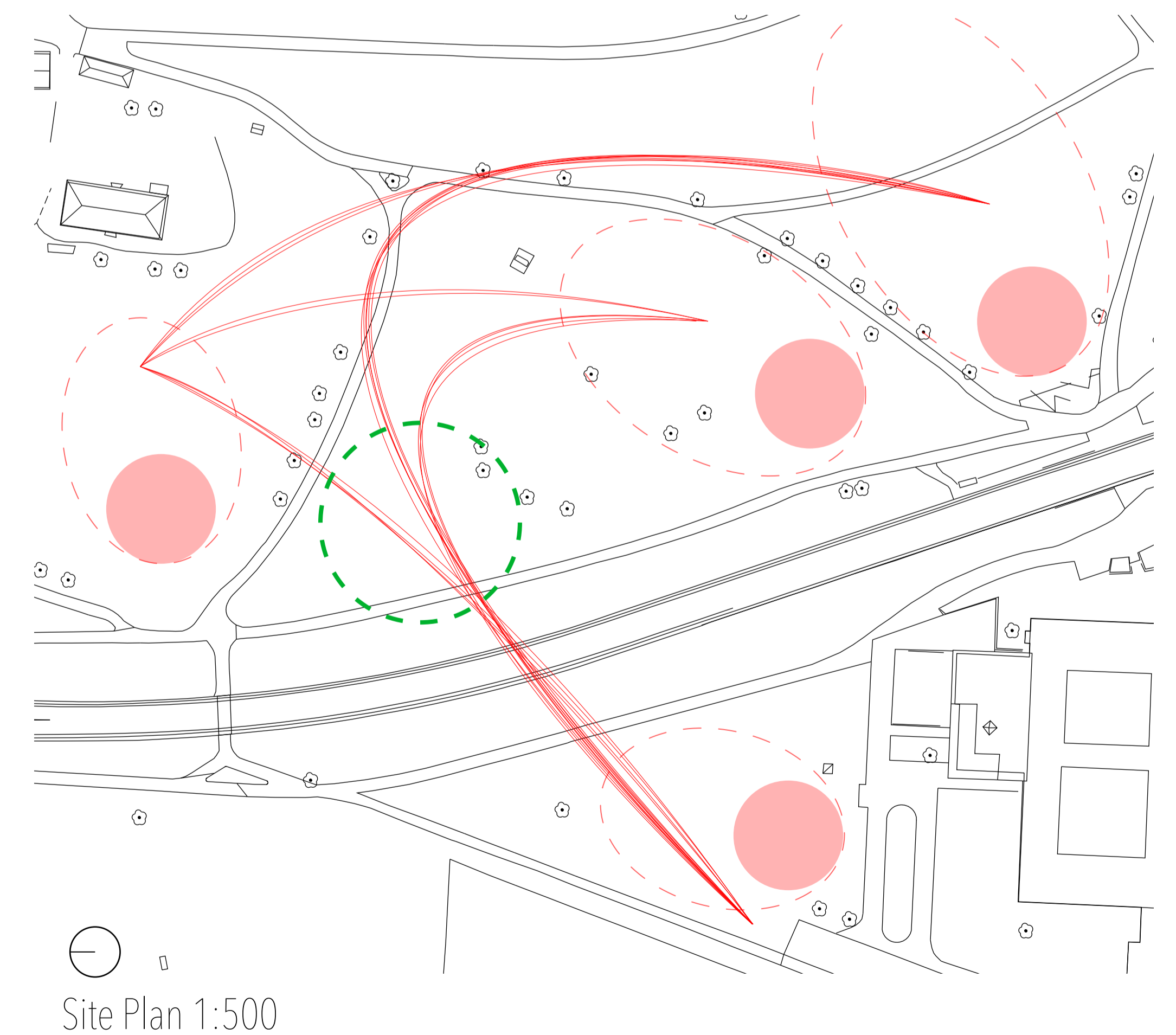

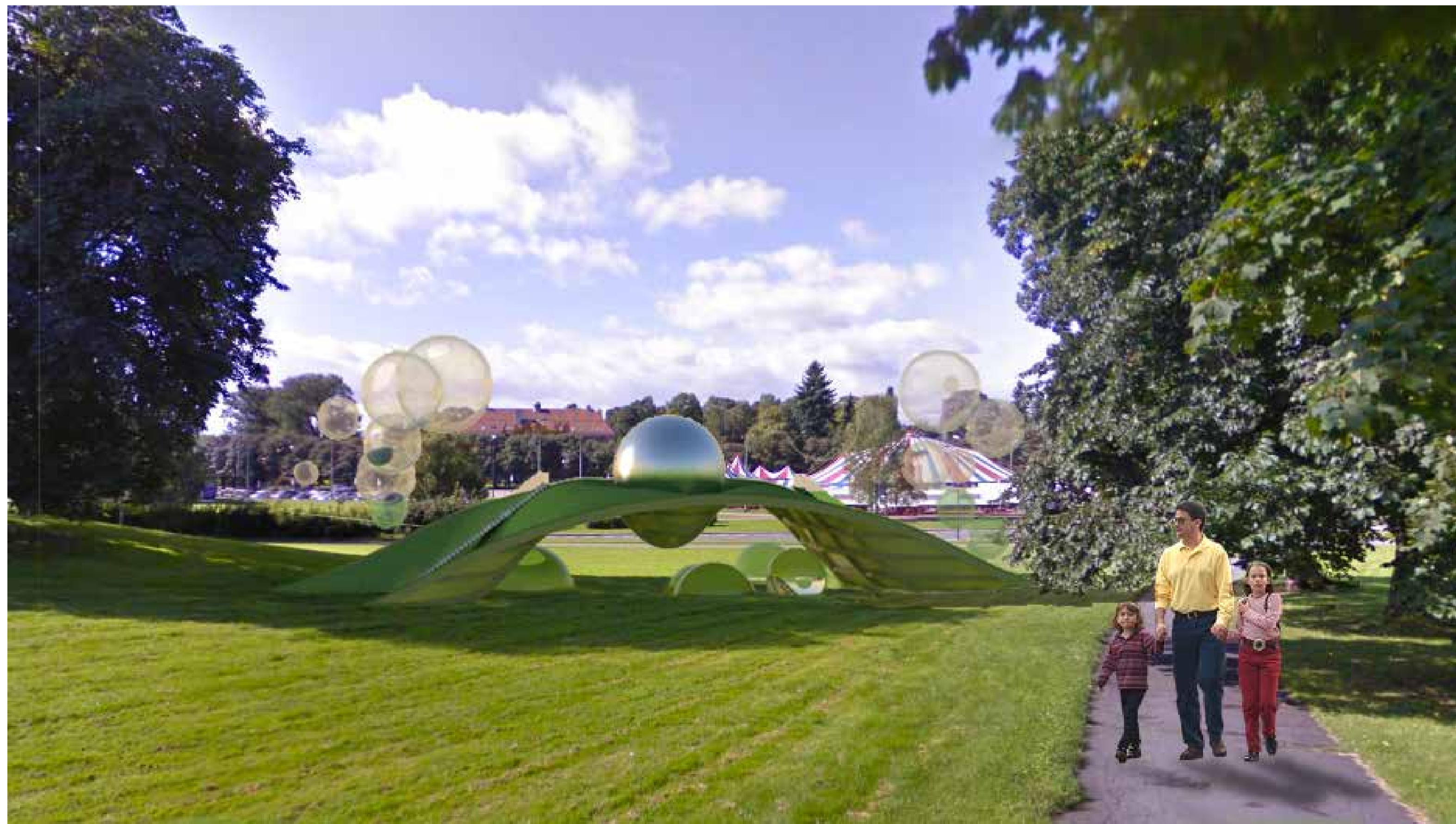
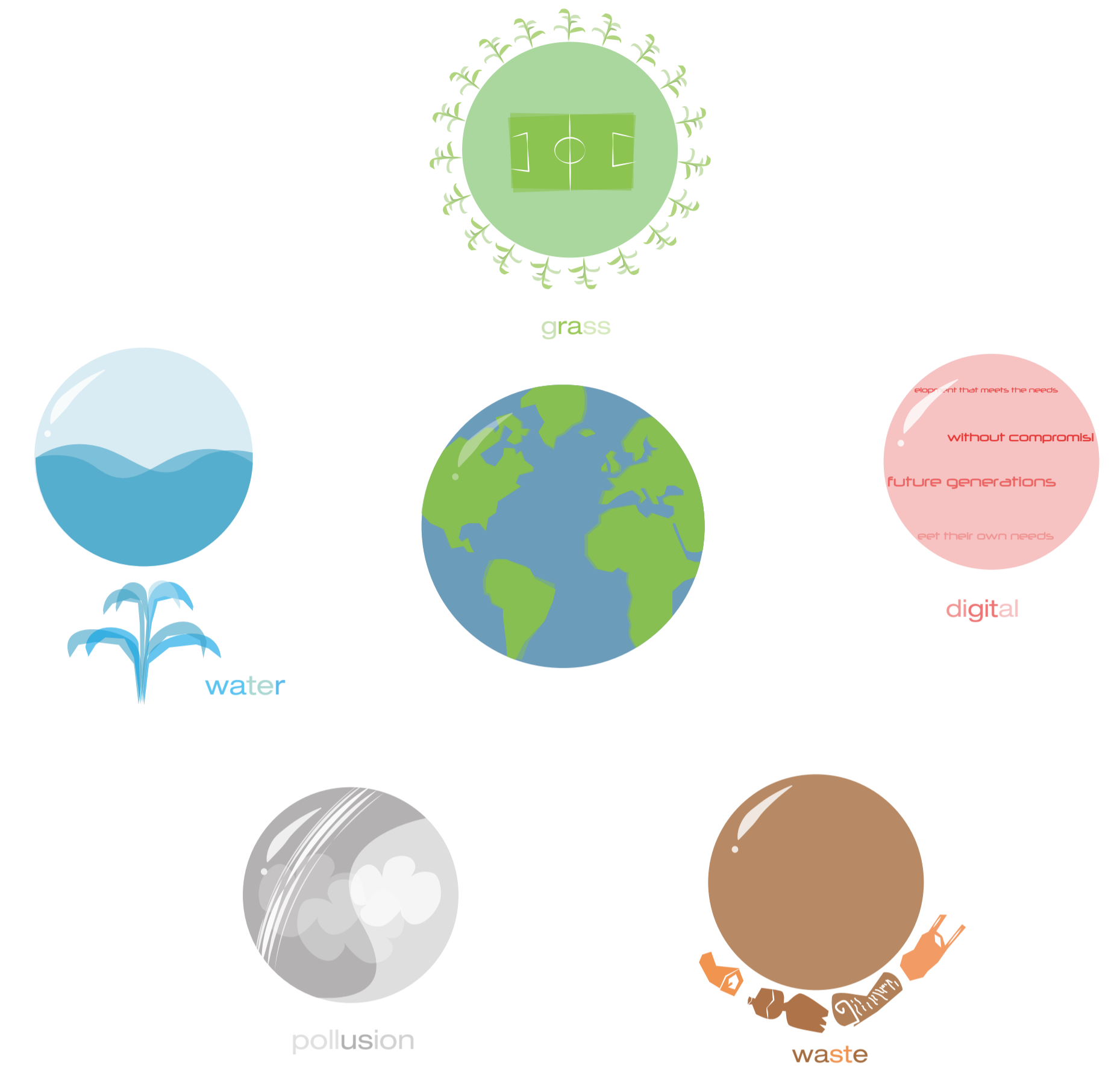

**Lithosphere/Waste**

The biggest concern at festivals, a spherical void in the ground lined with litter explored landfills and recycling.

**Biota/Deforestation**

Giving scale to deforestation and raising awareness of responsible timber sourcing.

**Atmosphere/Air Pollution**

Transport is another major polluter at festivals. A floating sphere gives scale to a tonne of carbon dioxide.

**Public Sphere/Digital**

A floating sphere displaying commentary and colourful visuals, a beacon at night. Interaction through social media highlights increasing influence of technology and virtual realm.

**Hydrosphere/Water**

A water feature encouraged interaction and refreshment, whilst raising awareness of the scarcity in parts of the world.