

CANTEEN

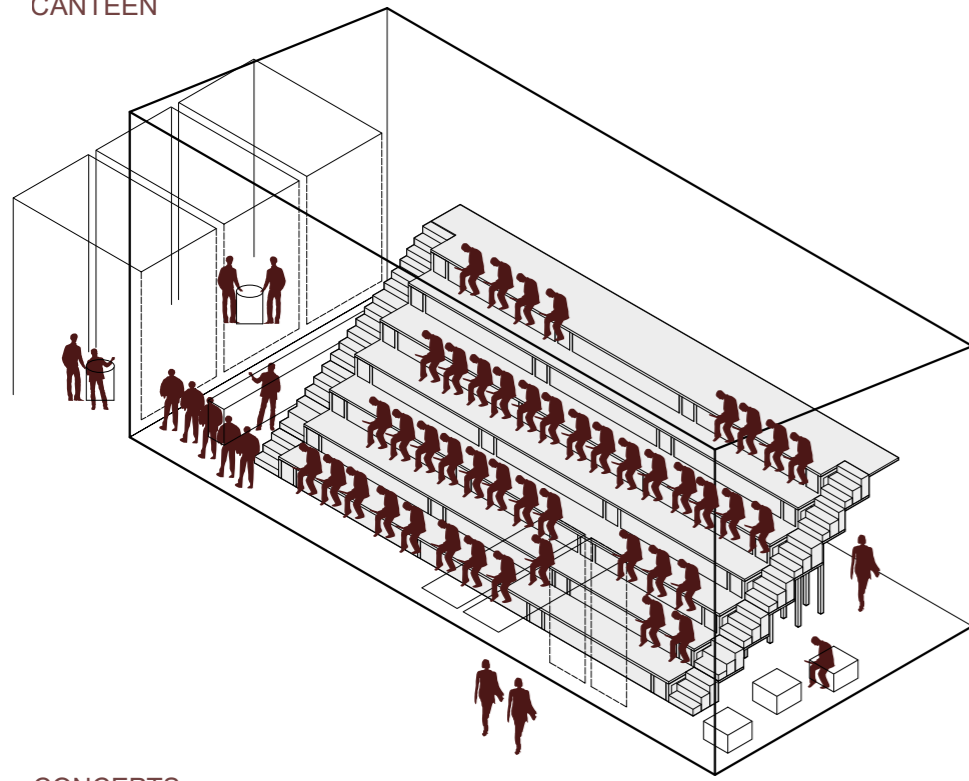

LIBRARY

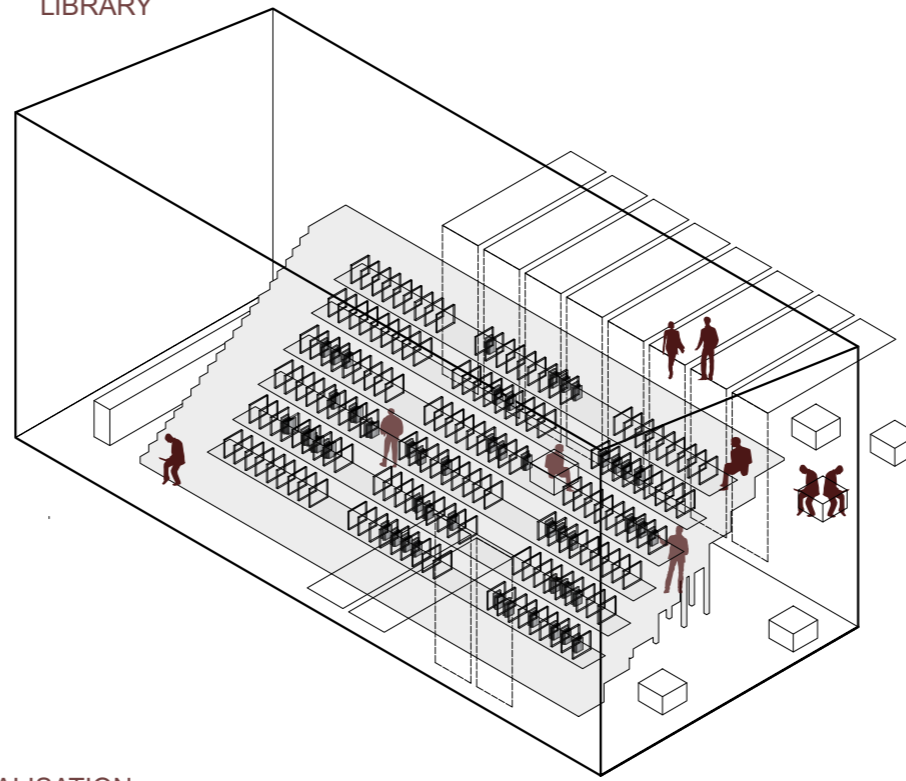

EVENT

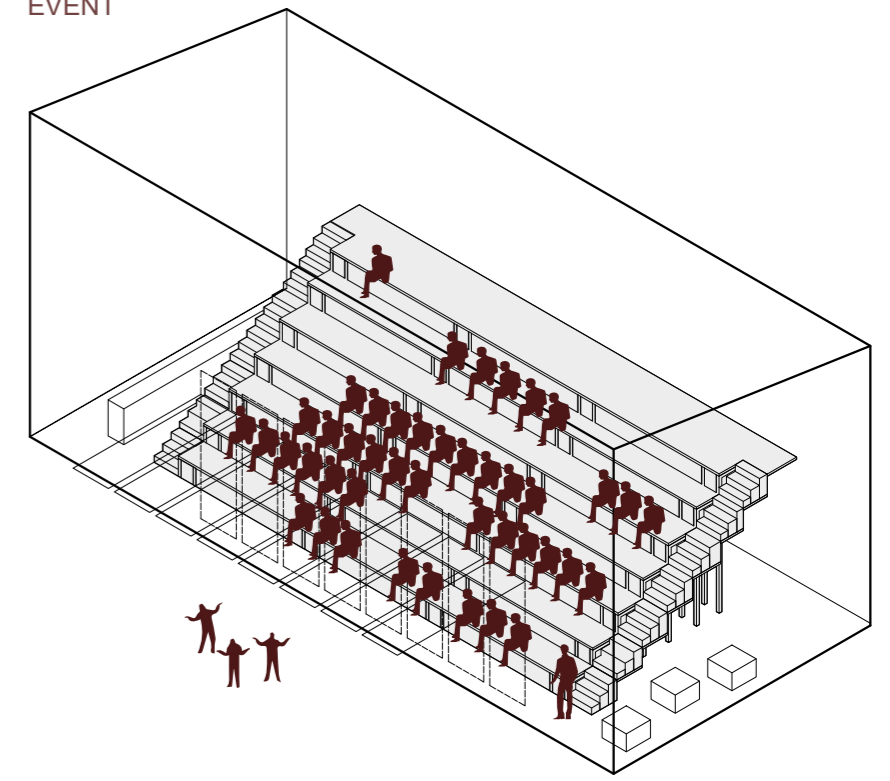

CONCEPTS

1. scenario

2. scenario

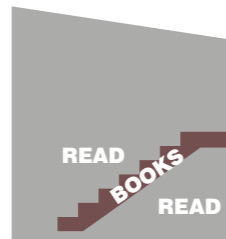
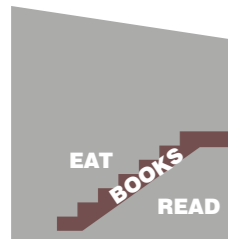

OUTSIDE COOKING SPACE

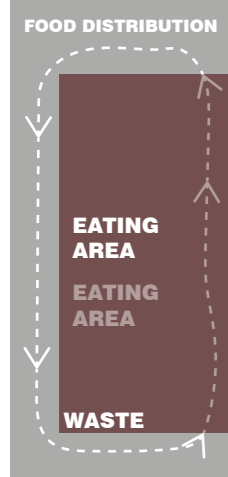

OUTSIDE EATING AREA

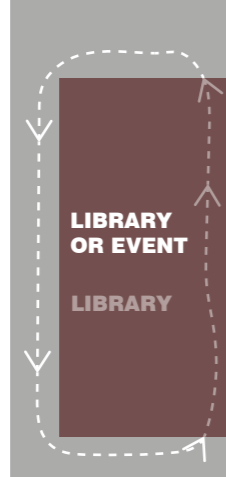

OUTSIDE READING AREA

VENTILATION

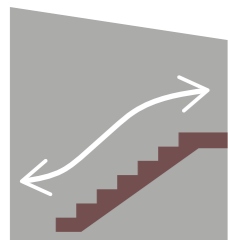

VIEWS

VIEW ON THE SCHOOL COURTYARD

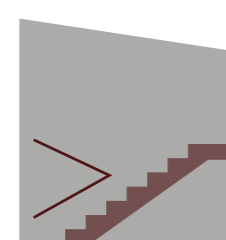

VIEW ON THE RICEFIELDS

VIEW ON THE GARDEN

VISUALISATION



FLOOR PLAN - 1:100

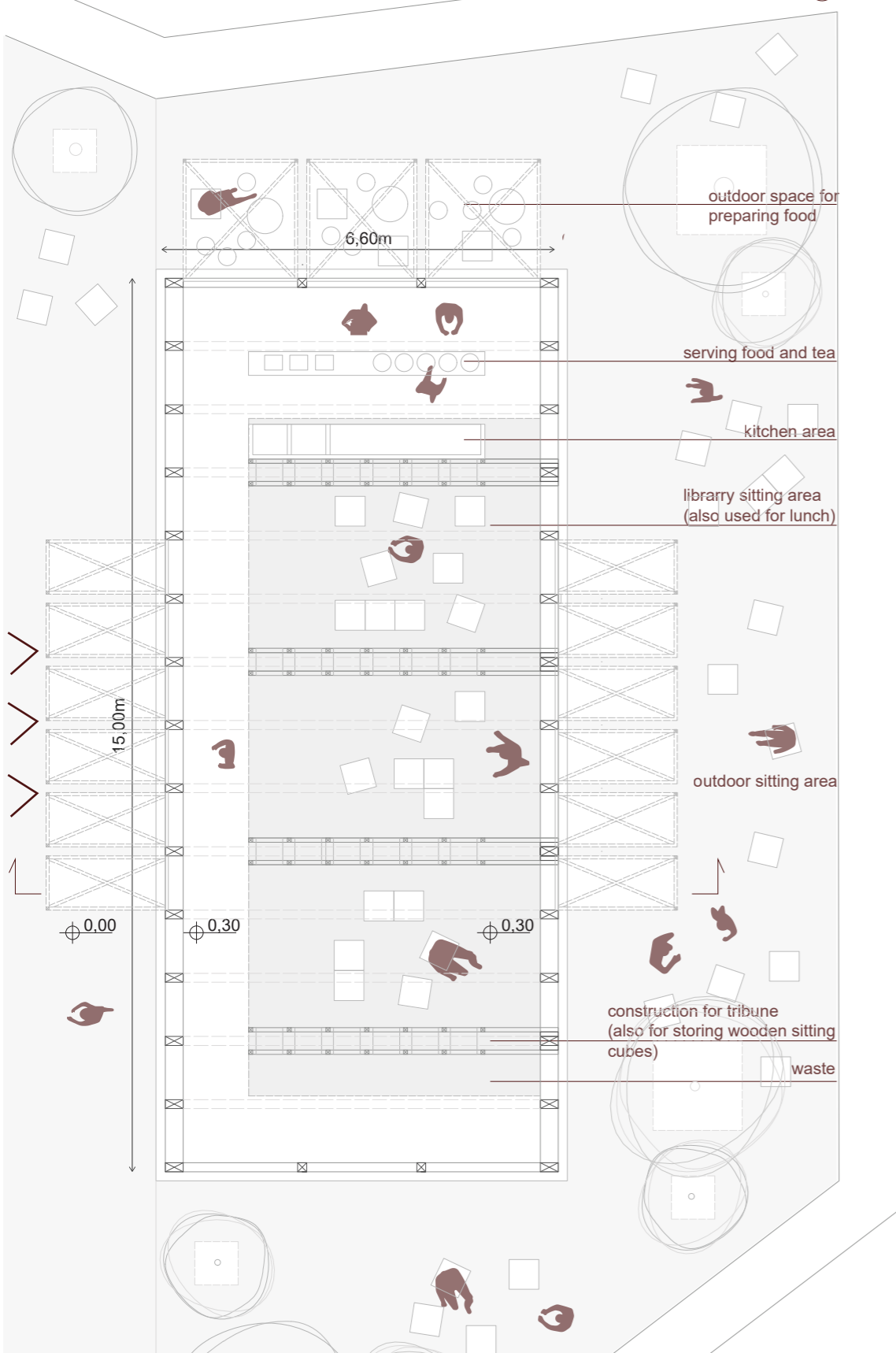

MULTIFUNCTIONAL ELEMENT - A TRIBUNE

This main element can accommodate all 200 students at the time.

Wooden tribune stores all the books and it creates a library beneath. In the construction of the tribune there is storage for all the additional modular wooden boxes for seating. A tribune can be also used as an event or lecture place.

ORIENTATION: tribune is oriented towards the courtyard and it serves as an extension of a central school area. Library is oriented away from the crowd overlooking the valley.

FLOOR PLAN - 1:100

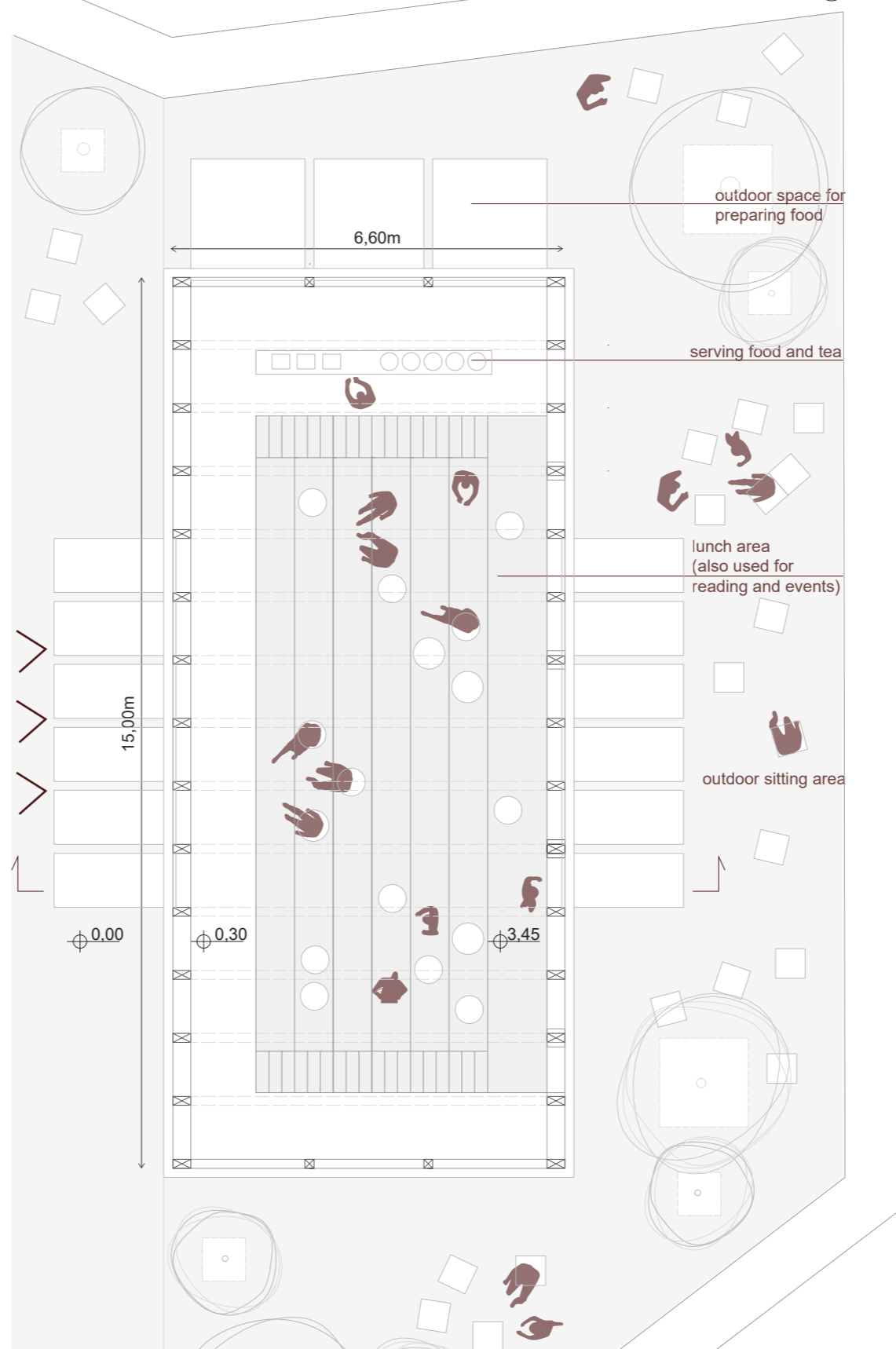

OPENINGS: tribune, library and serving food area can be extended outdoors through the openings in the facade creating a porch.

FACADE: polycarbonate - we used lexan that lets the light through and it is cheaper and lighter than glass. To prevent overheating we used bamboo sticks as shaders.

CONSTRUCTION: wooden frames

SECTION - 1:100

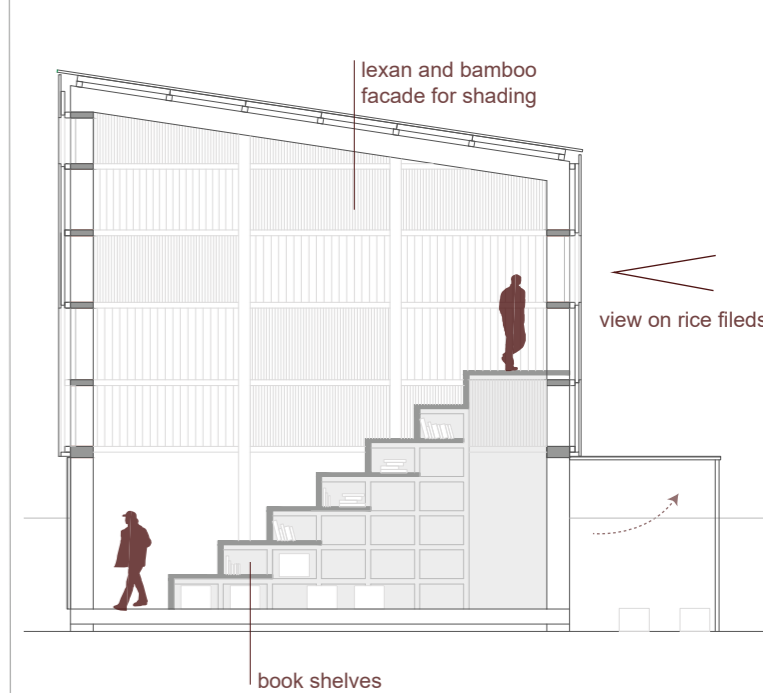

SITE PLAN

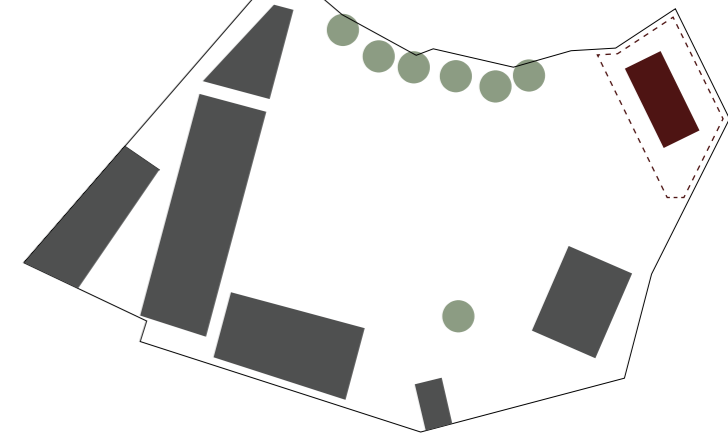

AXONOMETRIC CONSTRUCTION

